



EPWC1MEUKG

WATER PURIFIER

INSTRUCTION MANUAL



User Manual

CONGRATULATIONS! You are a special customer who has just purchased a product of Electrolux's world-class quality, with a modern and bold design and the state-of-the-art technology.

In this manual, you will find the information about how to use the appliance safely and properly.

Please read these instructions before using the product and keep this manual for future reference.

IMPORTANT

Keep the invoice of purchase of the product, because the warranty service is only valid upon its presentation to the Electrolux Authorized Service.

The Electrolux Authorized Service will use the identification tag in case the appliance needs repairing. Do not remove it from its attaching position.

Environmental Tips



The packaging materials are recyclable. Try to collect and send plastics, paper and cardboard to recycling companies.

This appliance may not be treated as household waste and must be delivered for disposal to an electrical and electronic equipment recycling system in compliance with local legislation.

Table of contents

1. Important Safety Instructions.....	2
2. Product Description	3
3. Product Features	4
4. Installation.....	4
5. How to Use.....	8
6. Cleaning and Maintenance.....	9
7. Troubleshooting.....	10
8. Technical Specifications	11

1. Important Safety Instructions

Please read these instructions before using the product. It is important to keep this Instruction Manual for future reference.

⚠ ATTENTION

This information is provided for your safety. You MUST read the manual carefully before installing or using the product.

This product is not intended for use by persons (including children) with reduced physical, sensory or mental capabilities, or lack of experience and knowledge, unless they have been given supervision or instruction concerning the use of the product by a person responsible for their safety.

Never leave lighted candles or incense on the product, as it may cause a fire.

Child Safety

Avoid accidents. After unpacking the appliance, keep the packaging materials out of the reach of children.

Do not allow children to play with the appliance even when it is switched off. Children should be supervised to ensure that they do not play with the product.

To the User/Installer

Check that the voltage of the product matches that of the power outlet before turning on the appliance. This product is sold in a single version that operates on with 127 - 220V and 220 - 240V automatically, without the need for any adjustment. Be sure to unplug the appliance from the power outlet before any cleaning or maintenance. Never disconnect the appliance by pulling on the power cord. Please pull on the power plug instead. Do not attach, twist or tie the power cord. If the power cord is damaged, contact the Electrolux Authorized Service for replacement in order to avoid any risks. To avoid electric shocks, do not touch the power cord with wet hands. Never attempt to repair the appliance by yourself. Always consult the Electrolux Authorized Service and use original spare parts. If parts are damaged, contact the Electrolux Authorized Service and purchase only original parts and accessories for their replacement. Examine water connections frequently. Under normal usage conditions, the water inlet hose should be replaced once a year.

2. Product Description

ATTENTION

This product was developed to purify and cool water. Do not use it to freeze any other type of beverage, as it may cause damages to the product resulting in loss of warranty. Disconnect the product from the power outlet and close the water flow when it is left unused for a long time.

This appliance was developed for domestic use and designed to be used with drinkable water that complies with the current legislation.

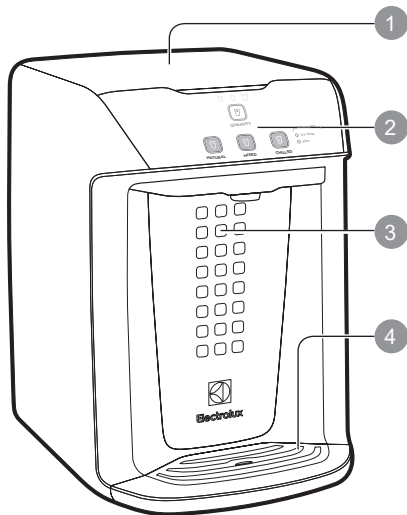

- 1 Cover
- 2 Control panel
- 3 Trigger
- 4 Water collecting grid (removable)

Accessories supplied with the product

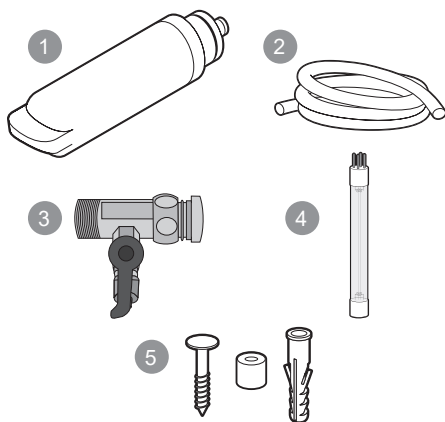

- 1 Filter refill (x1; model: PAUFCB30)
- 2 1/4" hose
- 3 1/2" adapter and 1/4" connector
- 4 UV lamp
- 5 Fixing screws and bushings (2 sets of 5 mm)

3. Product Features

Filtering System

This appliance purifies water at up to 3 stages, ensuring 100% treated water.

1. **Stage 1: Activated Carbon Filter**

Absorbs and removes color, odors, chlorine, oil, and dissolved gases in large quantities.

2. **Stage 2: UF Ultrafiltration**

Removes sediments like clay, sand, rust, algae, fungus and iron and other metals suspended particles, salt, etc.

3. **Stage 3: Ultraviolet Chamber**

The ultraviolet rays generated by the lamp have a high power with a short wavelength and are invisible to naked eyes. UV rays affect bacteria or microorganisms, leaving them inert and neutralizing them, which results in safe and completely purified water before consumption. The UV lamp is housed in a highly polished stainless steel tube to ensure good reflection of rays and multiple exposure of bacteria in a short time, increasing efficiency even when there is a group of bacteria.

The appliance produces a characteristic operating noise, i.e. the fan will always remain in operation. When it is identified that the water is cold, the rotation of the fan should be reduced but will never be switched off completely.

Dust accumulation in the product can cause the impression of a higher operating noise. Therefore it is suggested to clean the air filter as described on Page 9.

4. Installation

For your peace of mind, Electrolux has a highly qualified authorized service network to install the appliance.

An installation fee may be charged for this service. Such installation does not include site preparation service or the materials for the installation (e.g. masonry, electrical network, power outlet, circuit breaker, grounding, hydraulic network) as these would be the responsibility of the consumer.

ATTENTION

Before you begin the installation, please read all the information below carefully. The information is useful in executing the installation and ensuring that the appliance is installed correctly and safely. Store this manual in a handy place for future reference.

Installation site

Do not install the appliance in a place where it is exposed to direct sunlight or near heat sources such as a stove and oven.

This product must be installed in a place where it is easy to access for cleaning and maintenance. During installation, it is essential to ensure that the product is kept level, as tilting may result in leakage.

Make sure the site is strong enough to support the weight of the product filled with water (approximately 10 kg).

It is very important to keep the following minimum distances when installing the appliance on a bench or niche.

<i>Position</i>	<i>Minimum distance</i>
Left side	3 cm
Right side	3 cm
Rear	2 cm
Top	22 cm

ATTENTION

This appliance shall not be installed in a closed location.

Electrical Installation



Plug the appliance into a dedicated power outlet. Do not use extension cords or T-type connectors (benjamim). This type of connection may cause a fire and an overload on the electrical grid impairing the performance of your product.

For your safety, ask a qualified electrician to check the condition of the electrical grid at the appliance site. For details, contact the Electrolux Authorized Service.

The wires of the power outlet into which the appliance will be plugged must be in accordance with BS1363 type G. Check that the maximum allowable voltage variation at the installation site is as shown in the table below. If the supply voltage of the appliance exceeds the limits indicated in the Allowable Voltage Variation table, ask the power utility company to adjust the voltage levels or install a voltage regulator (stabilizer) with a power of 1000VA or less.

Allowable Voltage Variation		
Voltage (V)	Minimum (V)	Maximum (V)
127	116	133
220-240	201	255

Fixing the appliance on the wall (optional)

Fix the template on the wall at the desired height, make sure that it is kept level, and drill using the appropriate materials.

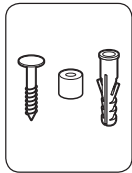

Place the two bushings and secure the two screws all the way. Fit the hooks located on the back of the appliance to the screws, and check that the product is fastened and leveled.

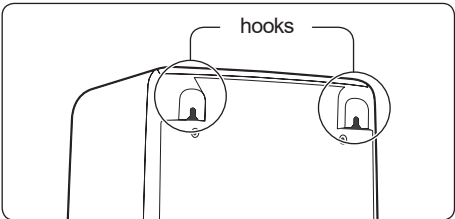

! ATTENTION
Do not put any objects on the product.

Water Pipe Installation

! ATTENTION
Do not turn on the appliance before finishing the installation of the water pipe.

- A 1/2" gauge tap is required near the installation site. The maximum distance between the product and the tap should be 1.5 m.
- The installation tap must provide drinkable water.

IMPORTANT
If you wish to use water from artesian or homemade wells, it is important to have a report that proves the indication that the water is drinkable and that it meets the requirements of drinkability established by the Ministry of Health. Subsequently, the water must be chlorinated to preserve it from possible contamination. The maximum flow rate of the product is approximately 2 liters/min while the tank is full.
The temperature of the mains water must be between 4°C and 38°C and the mains pressure between 4 and 40 mca (39.2 and 392.26 kPa) for the proper operation of the product.

IMPORTANT

Make sure that the water supply is closed in order to prevent leakage.

1. Remove the nut from the Metal Adapter with Valve and insert the PE Tubing through the nut. Slide the PE Tubing onto the protruding part of the Adapter where the nut was located until it reaches the threading.
2. Screw the nut tightly into place to keep the PE Tubing securely connected to the Metal Adapter with Valve. Make sure the Valve is in the off position (perpendicular to the PE Tubing).

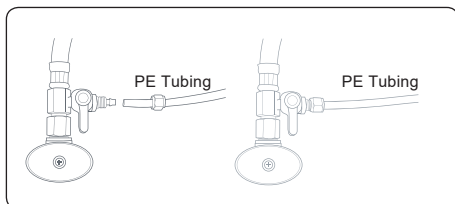

Figure 1

IMPORTANT

Make sure there is no leakage in the hose connections.

To prevent leakage, use sealing tape on the connections when necessary.

3. Push the tab of the water connection and remove the protection from the water inlet (Figure 2).

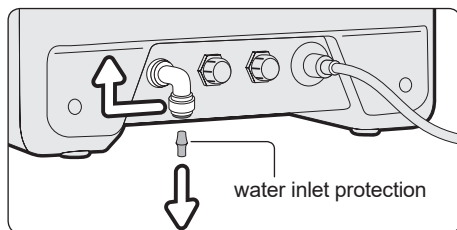

Figure 2

4. Fit the water inlet hose into the connection and push it all the way to the end (Figure 3).

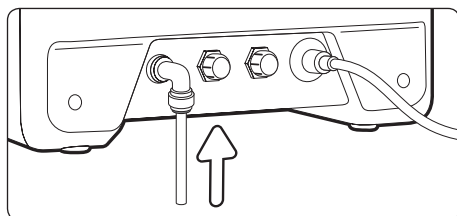

Figure 3

Filter Installation

1. Press the appliance cover to open it. (Figure 4)

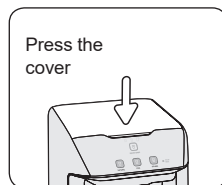

Figure 4



Figure 5

2. Open the appliance cover. (Figure 5)
3. Take the filter out of the packaging.
4. With the product turned on, connect the filter to the product and screw in the direction indicated until it is aligned with the arrow to lock it (Figure 6).

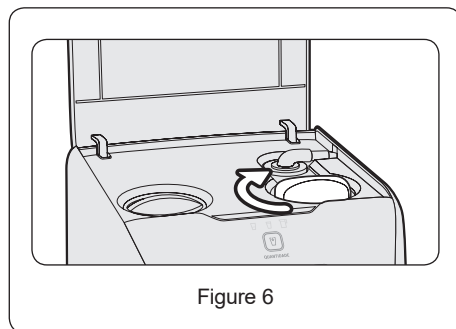

Figure 6

5. Open the water supply so that the product starts to be filled.
6. Press and hold the "RESET FILTER" button for 3 seconds.



⚠ ATTENTION

If the inlet pressure of the mains water is low during the removal of water from the product, interruptions in the water supply may occur until the internal tank is refilled again by the filter. In this case, you may re-locate the product (to a place of higher water pressure) or install a water pressurizer.

UV Lamp Installation

IMPORTANT

Make sure the appliance is unplugged.

1. Unplug the product from the power outlet and remove the lamp from the EPS housing.

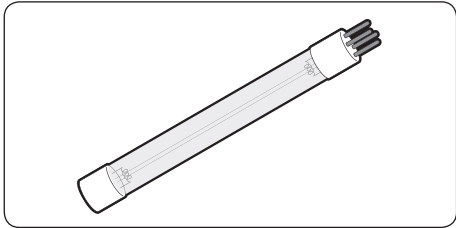

Figure 7

IMPORTANT

Be careful when handling the lamp as the tube is made of glass and may break.

2. Position the lamp carefully over the housing without releasing it (Figure 8).

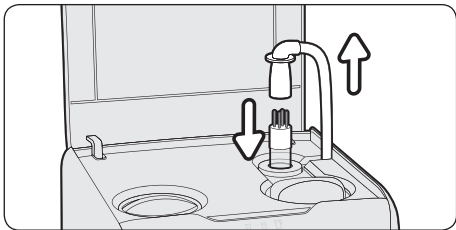

Figure 8

3. Connect the UV lamp to its power cable connector (Figure 9).

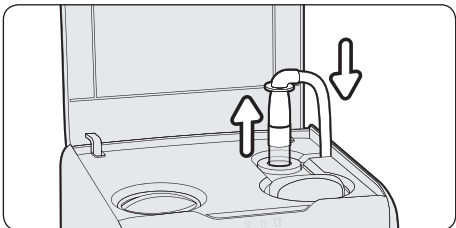

Figure 9

4. Snap the connector into the housing and attach the cable to the clip (Figure 10).

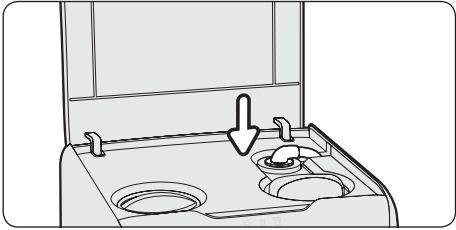

Figure 10

5. Plug the product into the power outlet and press the "RESET UV LAMP" button as shown in Figure 11.

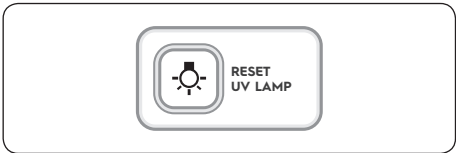

Figure 11

IMPORTANT

Before the first use, it is necessary to clean the product by following the instructions in Chapter 6, Cleaning and Maintenance.

5. How to Use

Control Panel

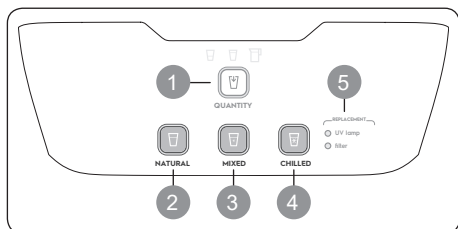

- 1 The key to select the water volume
- 2 The key to select natural water
- 3 The key to select mixed water (a mixture of natural and cold water)
- 4 The key to select chilled water
- 5 Filter or UV lamp replacement indicator

Operation

When the product is powered on, all keys and the filter or lamp replacement indicator remain lit for 1 second and then go off.

To get water through the trigger:

1. Select the temperature with a quick tap on the desired key.
2. Press the trigger with the cup to remove water.
3. Remove the cup to interrupt the water outlet.

To get water using the keys:



1. Select the desired quantity of water. The quantities of water for each portion are approximately 100 ml, 300 ml and 800 ml respectively.
2. Touch the Natural, Mixed or Chilled key so that the selected portion is served at the desired temperature.

TIPS

To obtain approximately 1 liter of water more quickly, press and hold one of the 3 water temperature selection keys for 3 seconds. To stop the water flow, tap on any key again.

⚠ ATTENTION

The appliance produces a normal noise while the cooling system is working and when the tanks are filled.

Filter and UV Lamp Indicator

The filter and UV lamp indicator will light up when one of these two components needs to be replaced.

The filter and UV lamp indicator will light up after 12 months of use, or after approximately 3000 litres of water consumed.

If the filter and/or UV lamp replacement indicator is on, refer to the next chapter for cleaning and maintenance of the product.

6. Cleaning and Maintenance

⚠ ATTENTION



Never clean the outside of the appliance with flammable fluids such as alcohol, kerosene, gasoline, paint thinner, solvents, chemicals or abrasives such as detergents, acids, vinegars or products that may leave odors.

Under normal usage conditions, installation and quality of the supplied water, the filter should be replaced when the saturated filter indicator lights up (after 3000 litres or 12 months from the start of using the filter, whichever occurs first).

Filter Replacement

Under normal usage conditions, the filter should be replaced when the saturated filter indicator lights up (after 3000 liters or 12 months from the start of using the filter, whichever occurs first).

If the filter needs to be replaced before the time described, it means that the quality of the water supplied to the product has reduced its life but without affecting the final quality of the water delivered by the product. See Page 10.

Close the water supply of your house, remove the old filter and insert the new one, open the tap and press the "RESET FILTER" button. These are similar to the filter installation guidelines on Page 6.

UV Lamp Replacement

IMPORTANT

Unplug the appliance from the power outlet to replace the lamp. Be careful when replacing the lamp to avoid injury.

If the UV lamp indicator lights up, unplug the product from the power outlet, close the water supply, remove the used UV lamp, and follow the steps of UV Lamp Installation (Page 7) to install the new lamp.

Grid and Water Collector

Periodically remove the grid and water collector for cleaning. Wash them with water and a neutral detergent.

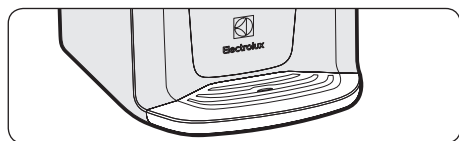

Water Tank

The water tank must be emptied for cleaning. Open the top cover, remove the plastic cover that protects the hole and pour a teaspoon (5 ml) of colorless alcohol vinegar. Open the water supply and wait for approximately 3 minutes until the tanks are filled. Pour another teaspoon (5 ml) of alcohol vinegar.

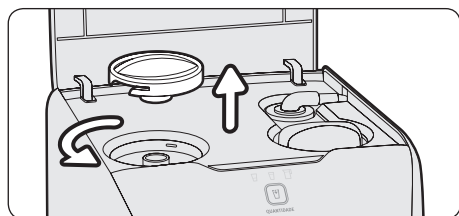

IMPORTANT

For the first use, add one (1) teaspoon (5 ml) of colorless vinegar to remove the residual plastic flavor, if necessary.

After 10 minutes, empty the tank using the drainage port located at the back of the product and discard the water.

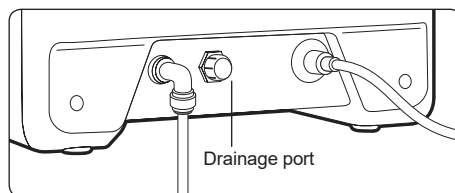

Allow the tank to refill with water and empty it by removing at least 5 liters from each tank (ice-cold and natural) before using it again to remove any vinegar residue from the tank.

Anti-dust screen

The appliance comes with an anti-dust screen, located at the bottom of the product, which has the function of retaining impurities present in the ambient air. This screen must be cleaned and the procedure is simple:

1. Press both clips that attach it to the bottom of the product simultaneously.

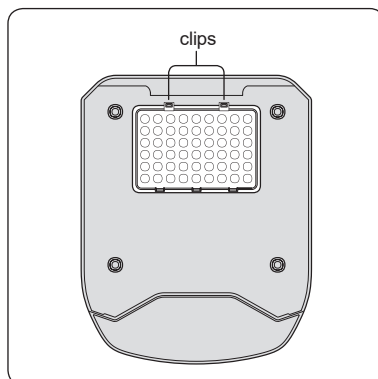

2. The cleaning is done manually, with the help of running water.

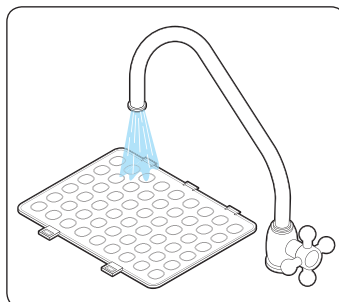

7. Troubleshooting

Customer Service

If the appliance presents any malfunction, quickly be corrected, without waiting for a technician. before calling the Authorized Service, check When the suggested corrections are not sufficient, call the Electrolux Authorized Service, below if the cause of the failure is not a simple one to solve or if there is no error in which will be at your disposal. the use of the product, which can easily and

Faults	Possible Causes	Corrections
Doesn't work / won't turn on	Outlet with bad contact.	Correct the fault in the power outlet.
	Power failure, circuit breaker off or blown fuse.	Wait for the power to return, turn on the circuit breaker or change the fuse.
Water with odor and/or taste	The product has not been used for more than 3 days.	Dispose of approximately 5 liters from each tank (ice-cold and natural) before consuming the water again.
	Odor coming from the product's water pipe.	Clean the product as instructed on Pages 8 and 9.
	The appliance indicating the need for filter replacement.	Replace the filter.
Water leakage	Loose pipe connection.	Make sure that the appliance's water pipe connections have been properly secured.
	Damaged connectors or hose.	Please contact the Electrolux Authorized Service.
No water comes out	Tap or water supply closed.	Open the tap or water supply.
	Filter not properly fitted.	Fit the filter correctly.
	Water pressure is too low.	Make sure the water pressure is above 4 mca (39 kPa).
	Check the UV lamp indicator	Replace the UV lamp
The water doesn't freeze	Check the air filter.	Clean the air filter.
	Check the installation.	The product must not be embedded, placed inside cabinets or places without ventilation.
	Clogged water filter before the time indicated in the Manual.	Check your hydraulic installation, clean the system such as water tanks and pipes, or contact your water supply company.
	No more water in the cold water tank.	The storage capacity of the cold water tank is 800 ml. <i>The Peltier electronic cooling system has a cooling recovery time of up to two and a half hours, depending on factors such as ambient temperature, inlet water temperature and frequency of use.</i>
The "Filter replacement" indicator does not go off.	The water filter replaced with the product switched off.	Replace the water filter with the product switched on.

8. Technical Specifications

Model		EPWC1MEUKG
Width (mm)		250
Height (mm)		358
Depth (mm)		314
Mass (Kg)		5.7
Voltage (V)		220-240
Frequency (Hz)		50/60
Maximum output (W)		73
Water pressure (kPa)		39 to 392.26 kPa
Design working temperature for inlet water		3 - 38°C
Protection class		IPX0 (indoor use)
Color		Silver
Natural water tank volume (ml)		900
Cooling capacity (l/h)		0.2
Power consumption (kW/h/month)		7.0
Cold water tank volume (ml)		800
Filtering System	Particle retention	Class A
	Free chlorine reduction	Approved
	Bacteriological efficiency	Approved
	Filtering element life	3000 liters or 12 months
	UV lamp life	3000 liters or 12 months

* Values according to BATS NBR 16236:2013.

This product is intended to be used in drinkable water that complies with local legislation.

If necessary, use a transformer of at least 1000VA.

IMPORTANT

Any use other than that specified herein may result in loss of warranty as per Chapter 9 in this manual.

WARNING:

This product is intended for domestic use and similar applications, such as:

- ***Kitchen for group use in stores, offices and other work environments;***
- ***Farm houses and by clients in hotels, motels and other residential environments;***
- ***Half-board environments;***
- ***Buffet and similar applications not intended for retail.***

Notes

This image shows a single page of white paper with horizontal ruling lines. The lines are evenly spaced and run across the width of the page. There are no margins, text, or other markings on the paper.

Notes

[illegible]

<https://www.electroluxarabia.com/support/contact-us/>

Electrolux Appliances S.P.A
Corso Lino Zanussi 24
33080 Porcia (PN)
Italy

